

# Self-adhesive film installation guide



# Tools Needed



**Glass Cleanser**

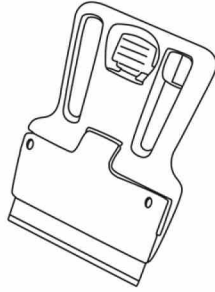

**Window Scraper**

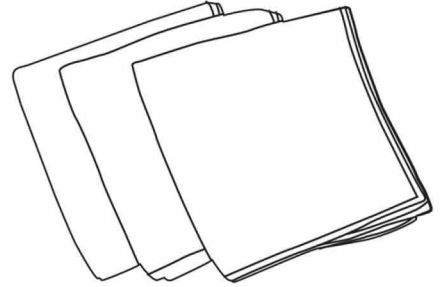

**Adsorbent Cloth (Lint Free)**



**Silicone Sealant (Non-acidic)**

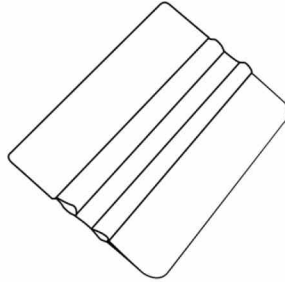

**Soft Edge Squeegee**

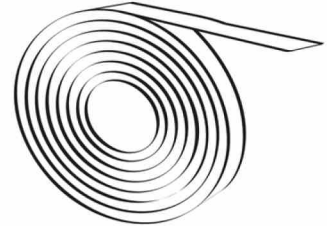

**Decorative Trim**

# Important information

- Please handle the smart film carefully. Make sure that the film is never folded, curved or bended. This will damage the liquid crystals inside the film. When handling the smart film, always let the film remain flat and straight.
- Please ensure the working environment is as clean as possible, avoid dust from getting on to the window surface.
- Please ensure that the protective layer stayed on during your installation to prevent the surface from being scratched by the squeegee.
- Do not work with the film when the film is connected with power

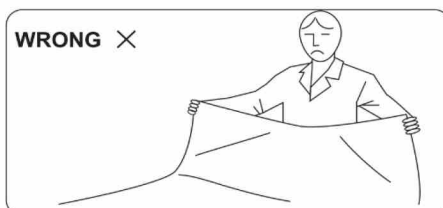
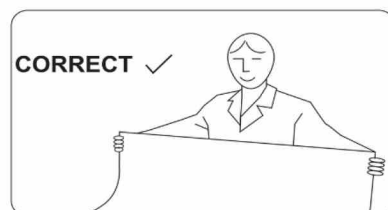
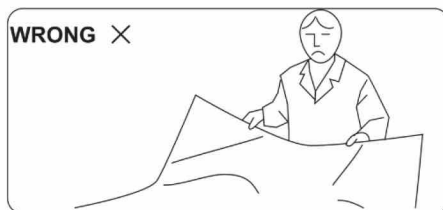

# Step 1

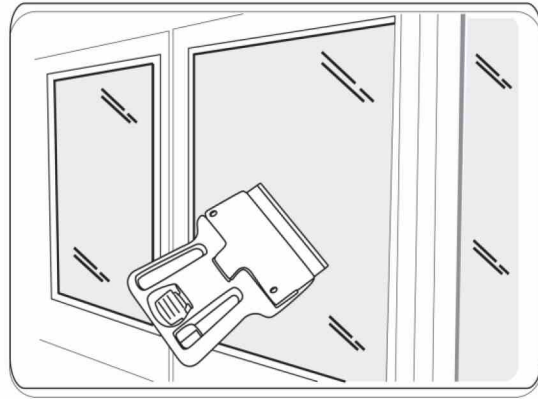

Use glass cleanser to thoroughly clean the glass surface on which smart film is expected to be installed. After cleaning, use a window scraper and a lint free adsorbent cloth to clean up any residue cleanser liquid and dust particles, the cleaned glass surface should be very smooth, free of dust and oil contaminants. Repeat cleaning process if necessary.

**Hint:** Please take as much as time as you need for this process. A cleaner glass surface will make the subsequent installation much easier and the end result much nicer.

## Step 2

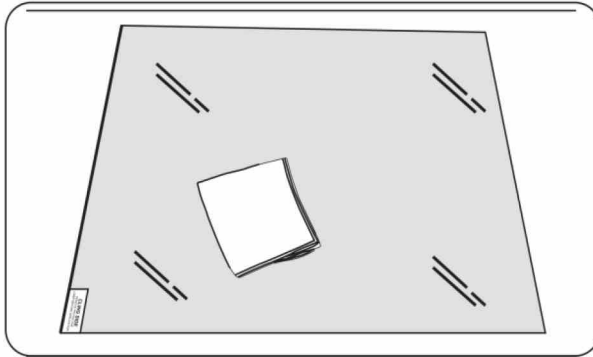

Use a lint free adsorbent cloth to carefully wipe down any dust particle that is absorbed on the two surfaces of the smart film due to static adhesion.

**Hint:** You might need two people to help you hold the film flat and straight while you wipe down the film. Do not bend or fold the film!

**Hint:** It is best to vacuum the floor or carpet before you unpack the film on it as this will minimize any possible dust from absorbing onto the film once in contact.

## Step 3

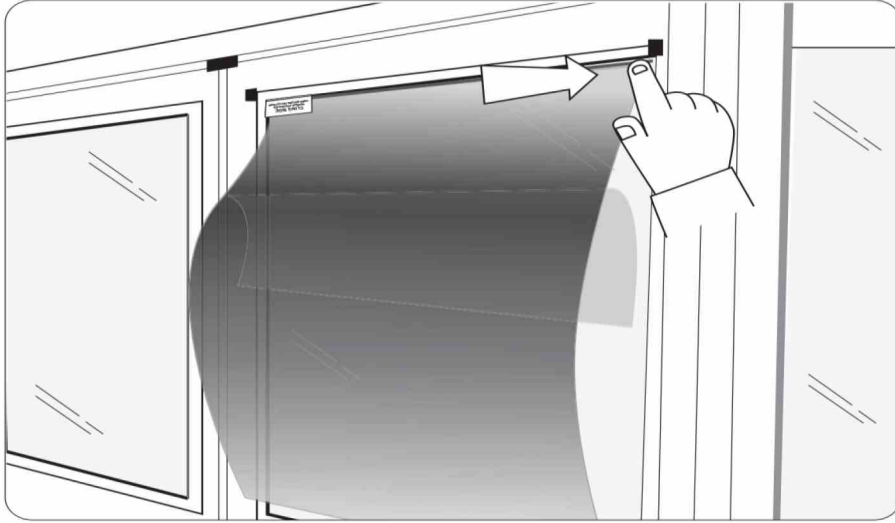

Before peeling the cling liner, hold the film to the window to make sure the size is correct. Use a marking tape to mark the right position of the film if you need to. Once you are ready to apply the film, peel the back cling liner off the top of the film by 1 inch and run your finger across the width to press the peeled part of the film against the glass. Once the top part of the film adheres to the glass surface, the adhesive at the back shall support the weight of the film. At this time, try to make sure again if the film is at the right position.

**Warning**: DO NOT use your nails to peel off the back liner as you might cause delamination of the film. Use a two tapes one adheres to the top of the film, one adheres to the back liner to separate them.

## Step 4

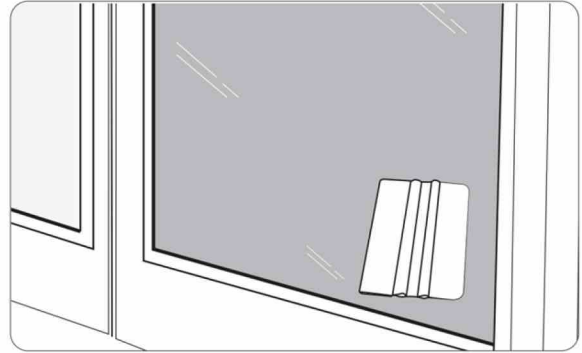
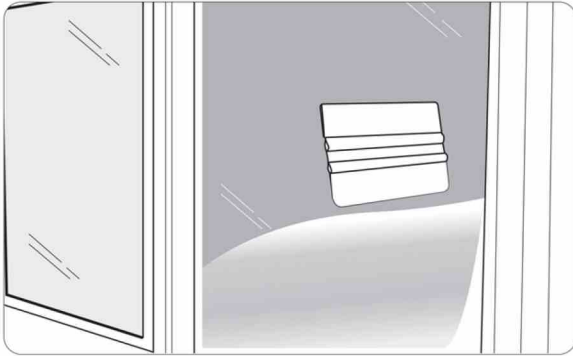

Slowly peel off the back liner (1 inch at a time recommended) and the weight of the film shall help it adhere to the glass surface. Use a squeegee to work horizontally on the film to push away any bubble trapped in between the film and glass surface

**Hint:** Use a soft edge squeegee to avoid work marks on the film.

**Warning:** DO NOT spray any water to help you apply the film. The water will contaminate the liquid crystals inside the film!

## Step 5

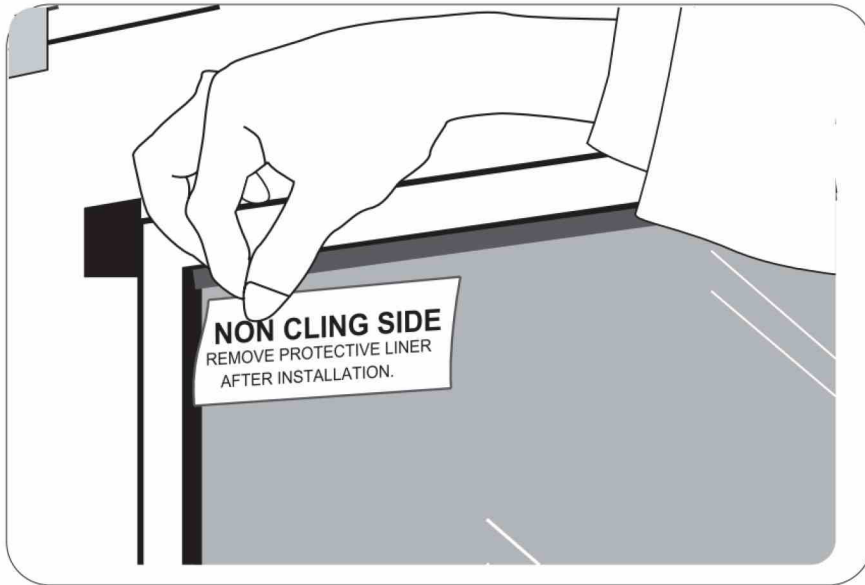

After the film was applied to the glass, lift off the corner of the top protector film using a small piece of tape and carefully peel off the protector film.



## Step 6

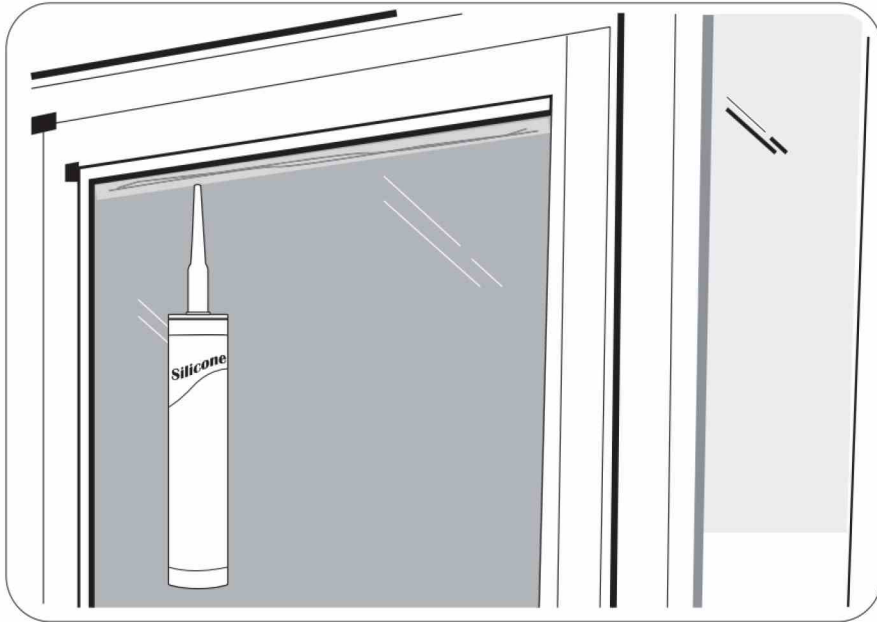

After peeling off the film protector, the connection of the film can be tested by connecting it to the power. The film shall turn from opaque to transparent once turn on. After making sure the connection is fine, the edge of the film shall be sealed off from contacting air and moisture by applying a thin layer of silicone. Decorative trim can be installed if necessary.

**Warning**: Only non-acidic silicone shall be used. (GE83 or Dow Corning 7091 will be recommended)