

Renovation Mart

# USER'S MANUAL

Please read this manual before you use this product.

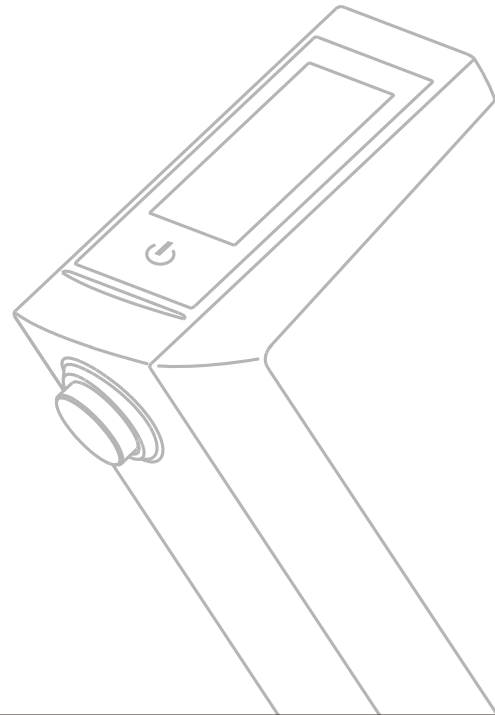

Features-----	1
Introduction-----	2
Product Construction-----	3
Operation of control panel-----	4
Operation of control panel-----	5
Operation of control panel-----	6
Operation of control panel-----	7
Installation guide of Faucet-----	8
Construction of Host Box-----	9
Construction of Host Box-----	10
Construction of Host Box-----	11
Construction of Host Box-----	12
Construction of Host Box-----	13
Installation guide of host box-----	14
Attention-----	15
Trouble Shooting-----	16

### **Touch control panel**

With touch control panel, easy to use.

### **Digital thermostat**

Keep outlet water TEMP stable, the TEMP accuracy within  $\pm 1^{\circ}\text{C}$ .

### **Overheat protection**

When the cold water cut off and lead the water TEMP over  $50^{\circ}\text{C}$ , system will stop water outlet in 2 seconds to protect user from hot water.

### **Water TEMP adjust**

You can set the water TEMP as you like.

### **Water saving**

You can adjust the water flow as you like, there is default working time, it's 18minutes, system will shut off as soon as time is up.

### **Prevent the water backflow**

The hot and cold water inlets adopt the special design, can effectively to prevent the water backflow when the hot and cold water pressure difference.

### **Cold, hot water pressure difference**

Our system can accept Max. 6:1 water pressure difference.

### **Double power supply, more safety and reliable**

The voltage of our product is 12V. we provide an external adapter, which can transfer 100-240V to 12V power supply. When local power cut off, the system still work by battery inside host box.

### **Easy Installation**

Faucet is made of brass and chrome polished. With base and standard connector, it's easy to install and match usual bathroom design.

. You can set the outlet water TEMP & water flow on touch panel as you like. Outlet water keep thermostatic TEMP. Complete set including the faucet with touch panel, host box and adapter.

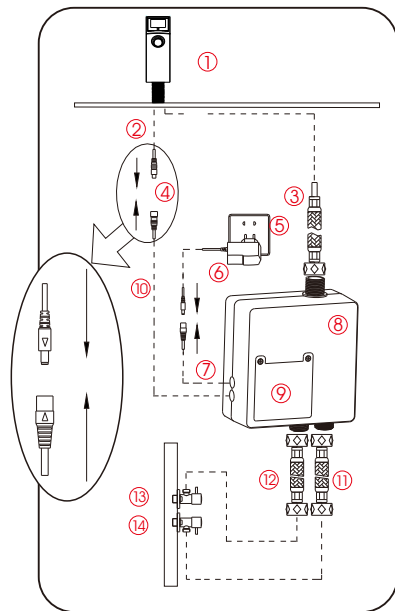

- ① Faucet
- ② Faucet's control cable
- ③ Thermostatic water outlet pipe
- ④ Control cable plug
- ⑤ AC220V plug seat
- ⑥ Power adapter
- ⑦ Power supply cable of the host box
- ⑧ Host box
- ⑨ Battery cover
- ⑩ Control cable of the host box
- ⑪ Hot water inlet
- ⑫ Cold water inlet
- ⑬ Cold water supply
- ⑭ Hot water supply from the water storage heater/solar type water heater/centralized heating system

**2**

The faucet is including the pipe and the LCD control panel.

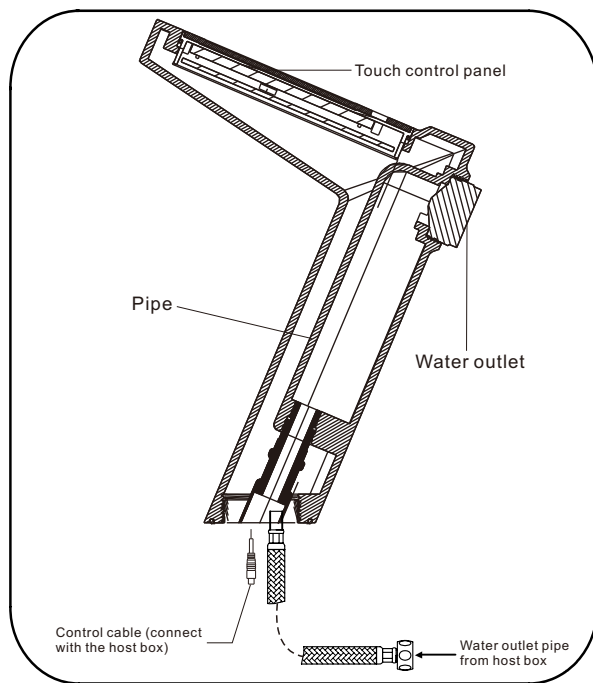

**3**





图1

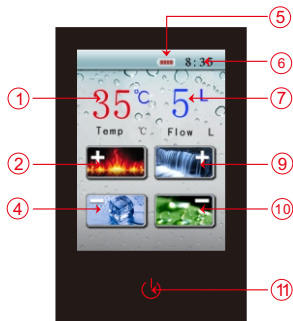

图2

- |                       |                       |
|-----------------------|-----------------------|
| ① Water TEMP Display  | ⑦ Water Flow Display  |
| ② Water TEMP setting  | ⑧ Water Flow Setting  |
| ③ Water TEMP Adjust + | ⑨ Water Flow Adjust + |
| ④ Water TEMP Adjust - | ⑩ Water Flow Adjust - |
| ⑤ Battery symbol      | ⑪ ON/OFF              |
| ⑥ Time countdown      |                       |



### 1. Power on/off

- To make your digital thermostatic faucet ON, just press .
- The screen will display the water TEMP & Flow when the system power on.
- When the battery charging, will show the charging state. After fully charged, the battery symbol will disappear.



### 2. Time Countdown

If the system is ON over 18 minutes, the system will shutdown automatically, and the screen will displays the countdown time.

### 3. Water TEMP Adjust

- Press touch water TEMP button   you can adjust the water TEMP. You can adjust the TEMP from 29°C to 45°C and the factory default is 38°C.
- Cold Water Function  
If you want to use the cold water directly, you can set water TEMP under 29°C. LCD screen display LO.
- Memory Function  
After electrify and turn on the faucet, the water TEMP will be same as that you set last time.

### 4. Water Flow Adjust

Press touch water flow adjust button   you can adjust the water flow from 3 to 13L and the factory default is 6L. When the panel is not touched in 5 seconds, system will go back to the interface (as picture 1 shows)

**Note: If the inlet water pressure is too low, the value of outlet water flow can not reach you set on the touch panel.**

### 5. Battery Low Alarm

(1). When power supply is come from battery, and battery almost use out, LCD screen will show low power warning. If battery has enough power to support system working for 5 minutes, the system shuts down when the time is up.

(2).When the low power warning icon appears, touch any button, warning icon disappear. Now touch any setting button is available; if LCD screen is not be touched in 6seconds, low power warning icon appears.



(3).When battery use out, warning icon will appear as below picture shows, and system shut off automatically after 5seconds.



### 6. Overheat Protection

When outlet water TEMP is over 50℃ , overheat icon appears as picture below, system shuts off within 5seconds. This moment touch buttons no response except power OFF button.

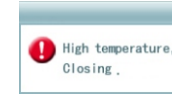

### 7. Chinese and English language switch

Above function support Chinese and English switch, system on after electrify in 3seconds, within 10seconds after power on, you can switch Chinese and English interface as followings:TEMP+, water flow+, water flow-, TEMP-; TEMP -, water flow - , water flow+, TEMP+.

### Technical Data:

- Input voltage: AC100-240V , frequency 50/60Hz
- Power consumption:3.2W
- Stand-by power:1.4W
- Waterproof rate:IPX5

### Working Condition:

- Environment TEMP : 1℃-45℃ Cold water TEMP: 4℃-29℃ Hot water TEMP ≤85℃
- The cold and hot water pressure:0.05MPa - 0.6MPa, suggest to install the reducing valve if water pressure over 0.6MPa.
- Faucet could be work with the water storage heater/solar type water heater/centralized heating system.

**Caution: If faucet work with the electric instant water heater or the gas water heater, outlet water TEMP from the water heater should not higher than 5℃ than the setting TEMP on faucet control panel.**

**Step 1** Open a hole(diameter 32mm) on the position of the basin where need to install faucet.

**Step 2** Put the rubber ring (Φ 40 X 2m) into the faucet base's groove

**Step 3** Through the water inlet pipe and the control cable of the faucet into the 32mm hole , and set the right faucet direction.

**Step 4** Screw the nut into the faucet base and tighten it.

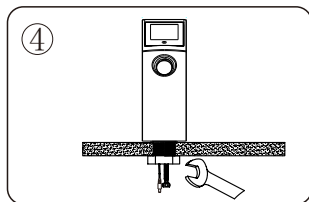
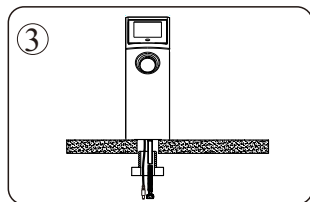
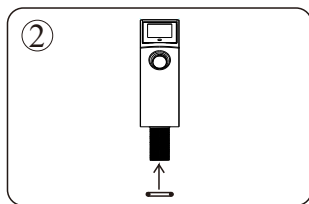
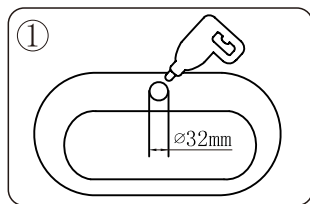

8

The host box has hot water inlet, cold water inlet, mix water outlet, control cable, power supply cable, battery cover and mounting bracket, see picture as below:

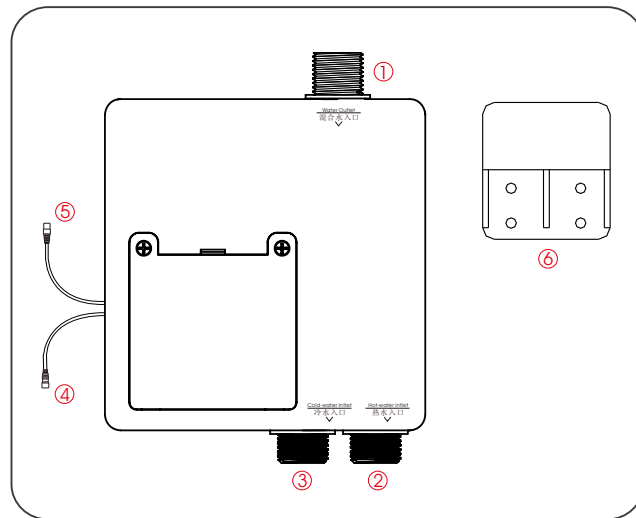

Size: 136 X 131X 65 mm

- ① mix water outlet    ② hot water inlet    ③ cold water inlet
- ④ control cable        ⑤ power supply cable    ⑥ mounting bracket

9

**Step 1** Drill four M3 holes on the position where need to install host box (as the picture) and put the plastic screw into the hole.

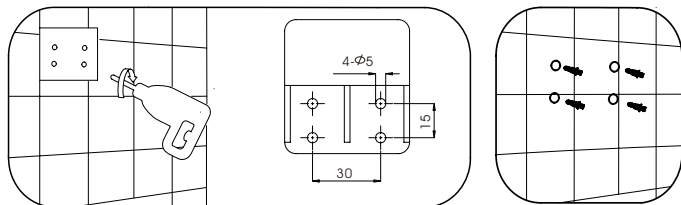

**Step 2** Fasten the mounting bracket onto the position by screws (M3x20) provided.

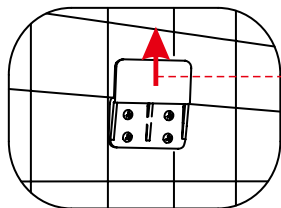

**Attention:**  
The mounting bracket should be installed upside as picture shows.

**Step 3** Loose the screws on the battery cover and take off it.

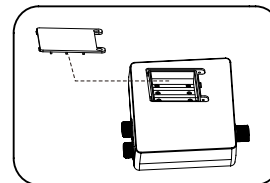

**Step 4** Put four rechargeable batteries into the host box.(as the picture)

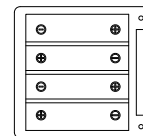
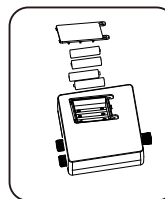

**Attention:**  
When put the battery into the host box ,you need to identify the anode and the cathode .

**Step 5** Put the battery cover into the host box, and lock it with the screws.

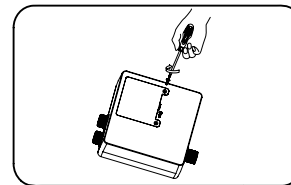

**Caution:**

- Must use rechargeable NI-MH battery [the 5#(AA) and the capacity is more than 1000maH.
- After electrify, can not use the normal 5#(AA) dry battery. If not, may cause the battery explosion.
- When the power cut, you can use the high quality normal 5#(AA) dry battery as the emergency measure. But you must unplug the adapter.
- When you install the host box, please put the battery into it. If the product haven't connected with the power in a long time. Please take out the battery from the host box. This way can avoid affect the battery working life.
- If you want to the battery with a longer working life, you can charge the battery every some months.

**Step 6** Connect the  $G\frac{1}{2}$ " hot and cold water inlet pipes to the host box, tighten it and make sure connection is well sealed (as the picture showed).

**Step 7** Connect the  $G\frac{1}{2}$ " faucet inlet water pipes to the host box, tighten it and make sure connection is well sealed (as the picture showed).

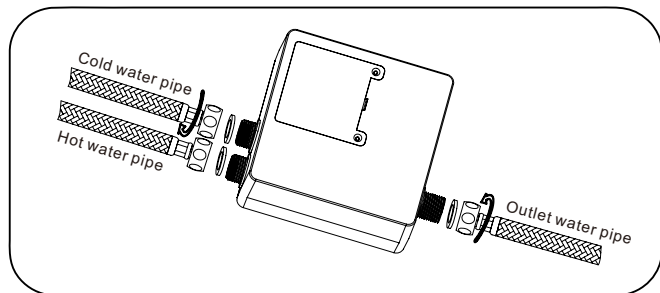

12

**Caution:**

- When installation, the hot water pipe and the cold water pipe can not mix up. Otherwise, the system can not work.
- When you tighten the connector nut, torque should not exceed 8NM, GB 2.5NM is OK, otherwise, it will damage the connector of the mixing valve, and lead to water leaking of host box.

**Step 8** Insert the host box that connected with water inlet pipe into the mounting bracket (as the picture ).

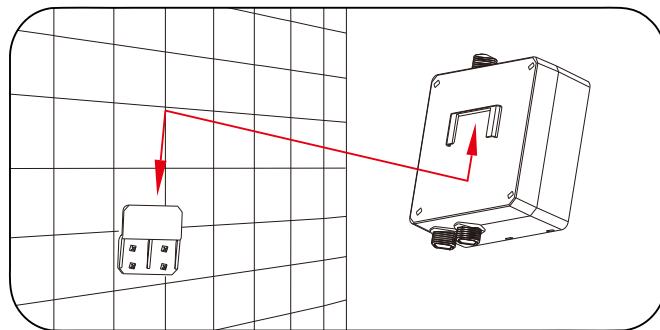

13



**Step 9** Connect the host box control cable with the faucet body's control cable follow the arrow mark.

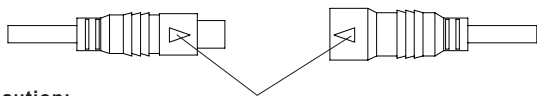

**Caution:**  
When connect the two control cables, must follow the arrow mark which shown in the cable joint. If not, will damage the cable joint.

**Step 10** Connect the power supply cable of the host box with adapter.



- The cold and hot water pressure:0.05MPa - 0.6MPa. For safety, suggest to install a water pressure reducing valve when water pressure over 0.6MPa.

- SJ-F200 don't have heating function. It should be working with water storage heater/solar type water heater/centralized heating system. Max hot water TEMP should not be more than 85℃. if not necessary, we suggest the user set the hot water TEMP below 65℃.

**Caution:** If working with the electric instant water heater or the gas water heater, hot water TEMP from heater can not set higher than 5℃ than the preset water TEMP on faucet.

- For safety, you can detect the water TEMP by hand before bathing.
- After electrify, the system can charge the rechargeable NI-MH 5#(AA) battery automatically.
- When the power cut and without the rechargeable NI-MH 5#(AA) battery, you can use the normal 5#(AA) dry battery as the emergency measure. But you must unplug the adapter, and when the electricity recover, you need to take out the dry battery, If not, will cause the battery explosion.

- The rechargeable NI-MH 5#(AA) battery would use out after long time delivery, please put the battery as instruction and charge it after electrify the system.

**Caution:** You must unplug the adapter before using the normal 5#(AA) dry battery.

## Trouble Shooting

Problem	Possible Reasons	Solution
Water flow low	settled water flow too low	set higher water flow
	low water pressure	check the water supply
	the faucet outlet use the water flow limit design	needn't to solve
Outlet water TEMP is lower than the display TEMP	water outlet pipe is too long, lead the TEMP cold down	shorter the pipe between the mixer and the shower faucet
	the TEMP haven't been adjusted steady	please wait the TEMP adjust steady
	set the water flow too low	needn't to solve
	Water TEMP from heater is cold	Increase water TEMP from heater
	malfunction on host box	please contact the factory
Outlet water TEMP is higher than the display TEMP	the TEMP haven't been adjusted steady	please wait the TEMP adjust steady
	the running water TEMP is higher than the setting TEMP	needn't to solve
	malfunction on host box	please contact the factory
Response time of TEMP adjust is slow	Low water flow	needn't to solve
	long time not use the hot water, cold down in the pipe and the hot water pipe is too long	shorter the pipe distance between the heater and the faucet and so you can drain the cold water in pipe quickly
	malfunction on host box	please contact the factory
Overheat alarm	no cold water supply	check the cold water supply pipe, fix problem before turn on shower faucet
	malfunction on host box	please contact the factory
The touch button not sensitive	too much water on touch panel	clean the water
Outlet water TEMP is not stable when faucet work with instant water heater, gas heater or the centralized heating system because heater not work always	The electric instant water heater and the gas water heater's can not work if water flow low than it's default value	1. For gas heater or instant heater, it won't work for low water pressure. Set almost same water TEMP of gas heater and instant heater as that settled on faucet. 2. Increase the water flow of faucet.